

Installation Guide

CMT series

Installation Guide for CMT series Ceiling Plates.

CMT-P



CMT-CH



CMT-TP



CMT-T50



SAFETY INSTRUCTIONS

1. Only entrust loudspeaker mounting equipment to experienced professionals. Also strictly follow the provided safety instructions. Improperly installed mounting equipment may result in property damage, personal injury and/or liability for the installing contractor.
2. **Always use safety cables!** This will prevent equipment from falling during/after setup and while exploiting.
3. Always check if the wall surface is structurally strong enough to support load. Make sure the wall and/or ceiling structure allows to hold the weight of the speaker including its bracket.
4. Only use appropriate fasteners.
5. Always make sure to securely use and tighten/lock all mounting bolts provided. Loose bolts may become unscrewed over time due to vibration which could potentially create a safety hazard when not tightened securely.

Installation Guide

CMT series

CMT-D fixed



CMT-D6



CMT-D10



CMT-D15



CMT-D20



CMT-D30



CMT-D60



CMT-D90



CMT-D120

CMT-D telescopic



CMT-D24-32



CMT-D32-48



CMT-D44-72



CMT-D112-200

Installation Guide CMT series

Installation Instructions:

CMT-P

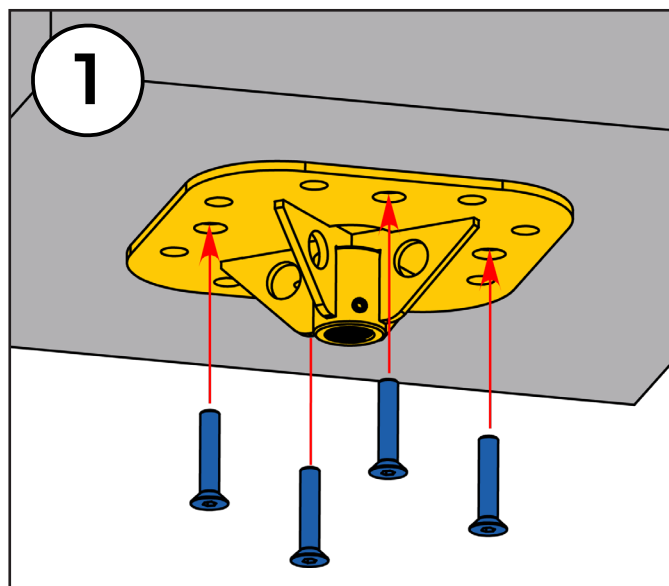

1. Screw the bracket to the ceiling by using all (4) screw.

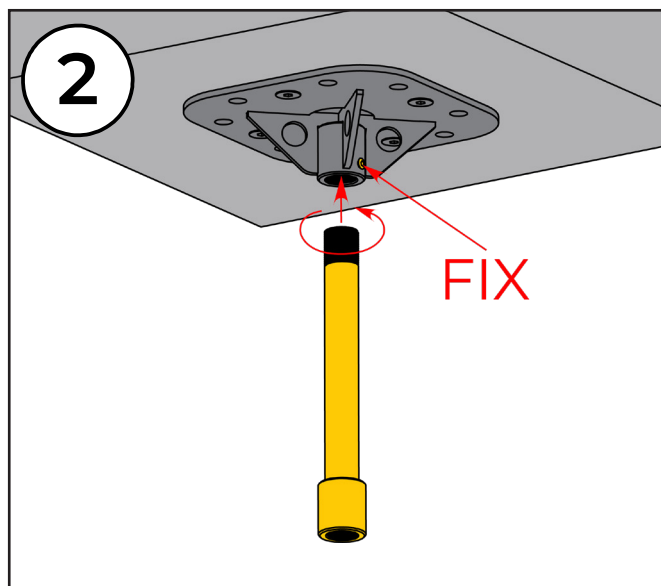

2. Install (screw) the distance tubes that bracket. And tighten the fixing bolts to lock.

CMT-T50

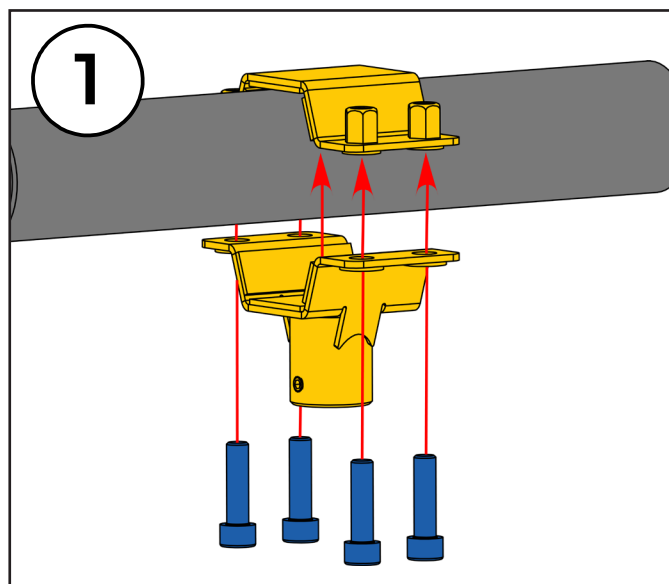

1. Screw the bracket to the ceiling by using all (4) screw.

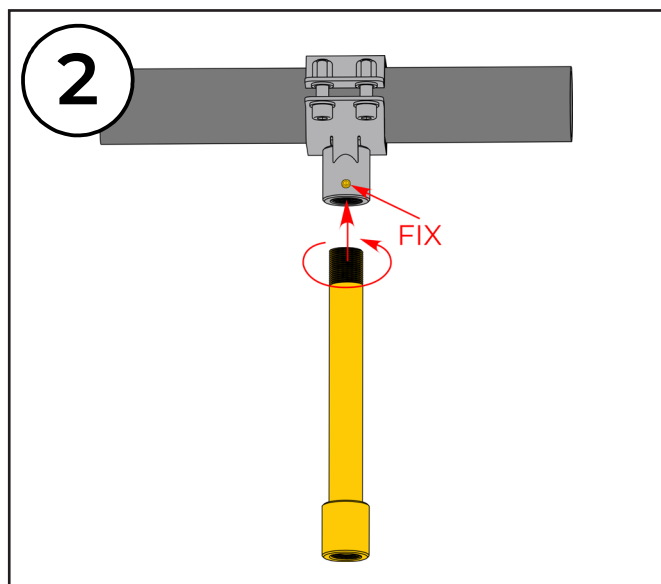

2. Install (screw) the distance tubes that bracket. And tighten the fixing bolts to lock.

Installation Guide

CMT series

CMT-TP

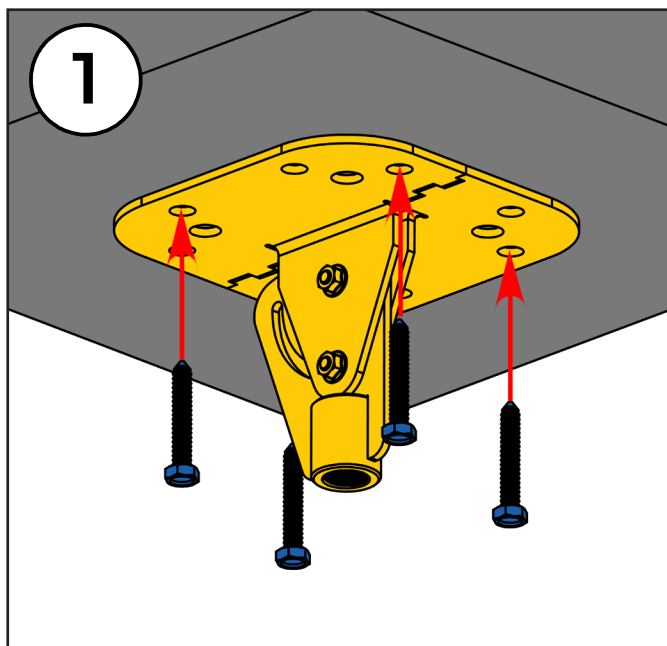

1. Screw the bracket to the ceiling by using all (4) screw. Use for uneven ceilings.

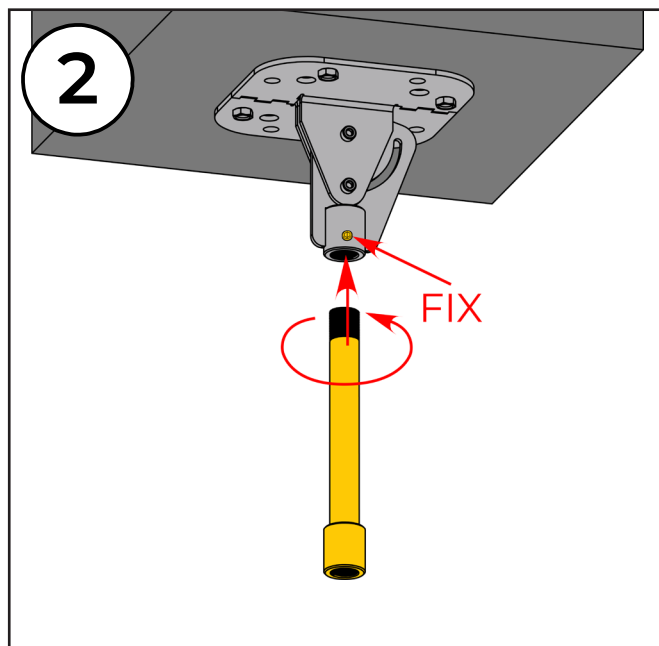

2. Install (screw) the distance tubes that bracket. And tighten the fixing bolts to lock.

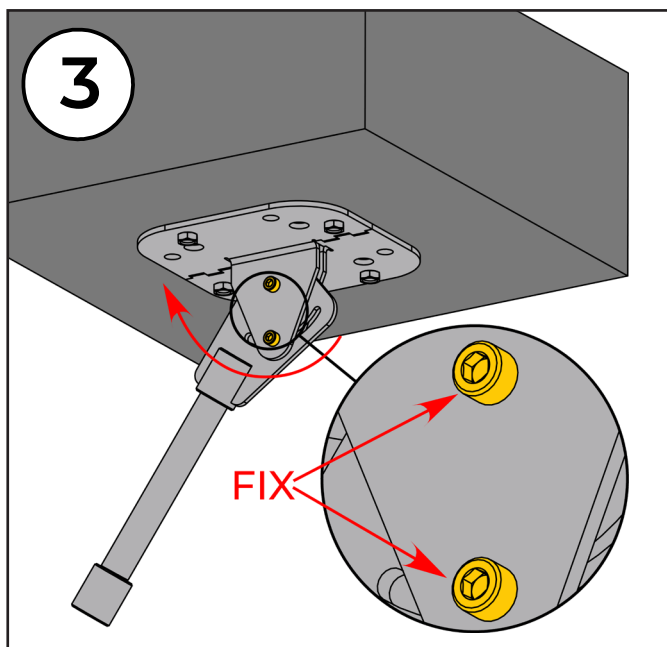

3. Adjust the tilt distance tubes of the bracket and tighten the fixing bolts to lock in the position of your need.

Installation Guide

CMT series

CMT-CH

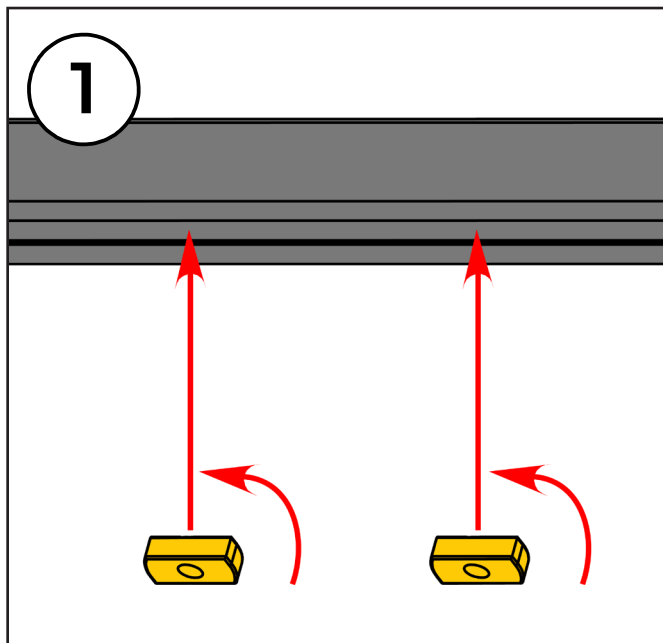

1. Insert the channel retainer nut into the U-shaped profile and turn it 90° until it stops.

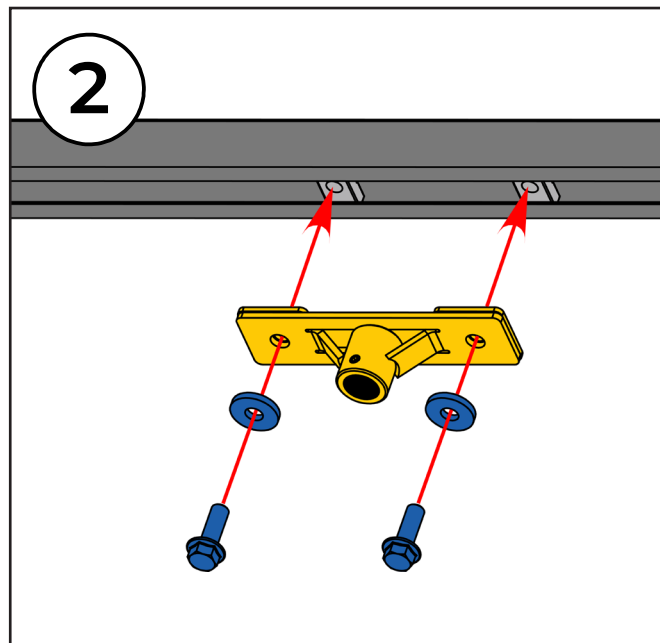

2. Screw the bracket into the channel retainer nuts to the U-profile by using all (2) screw.

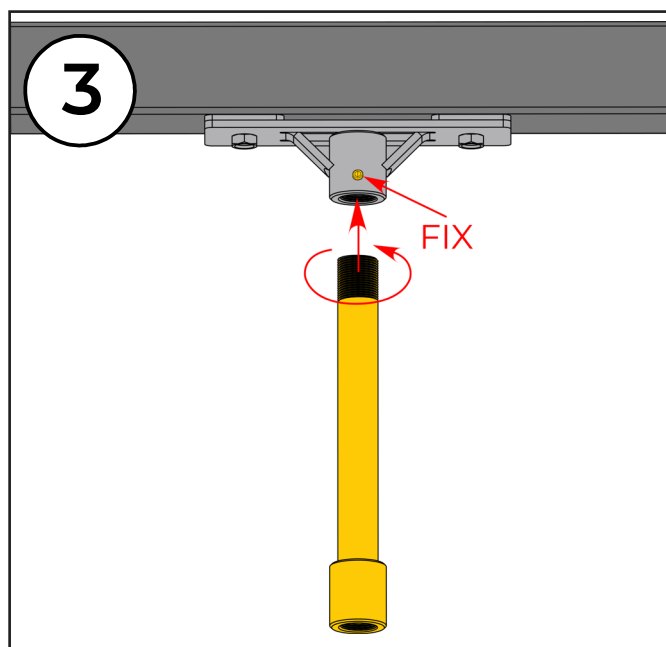

3. Install (screw) the distance tubes that bracket. And tighten the fixing bolts to lock.

Installation Guide

CMT series

CMT-D telescopic

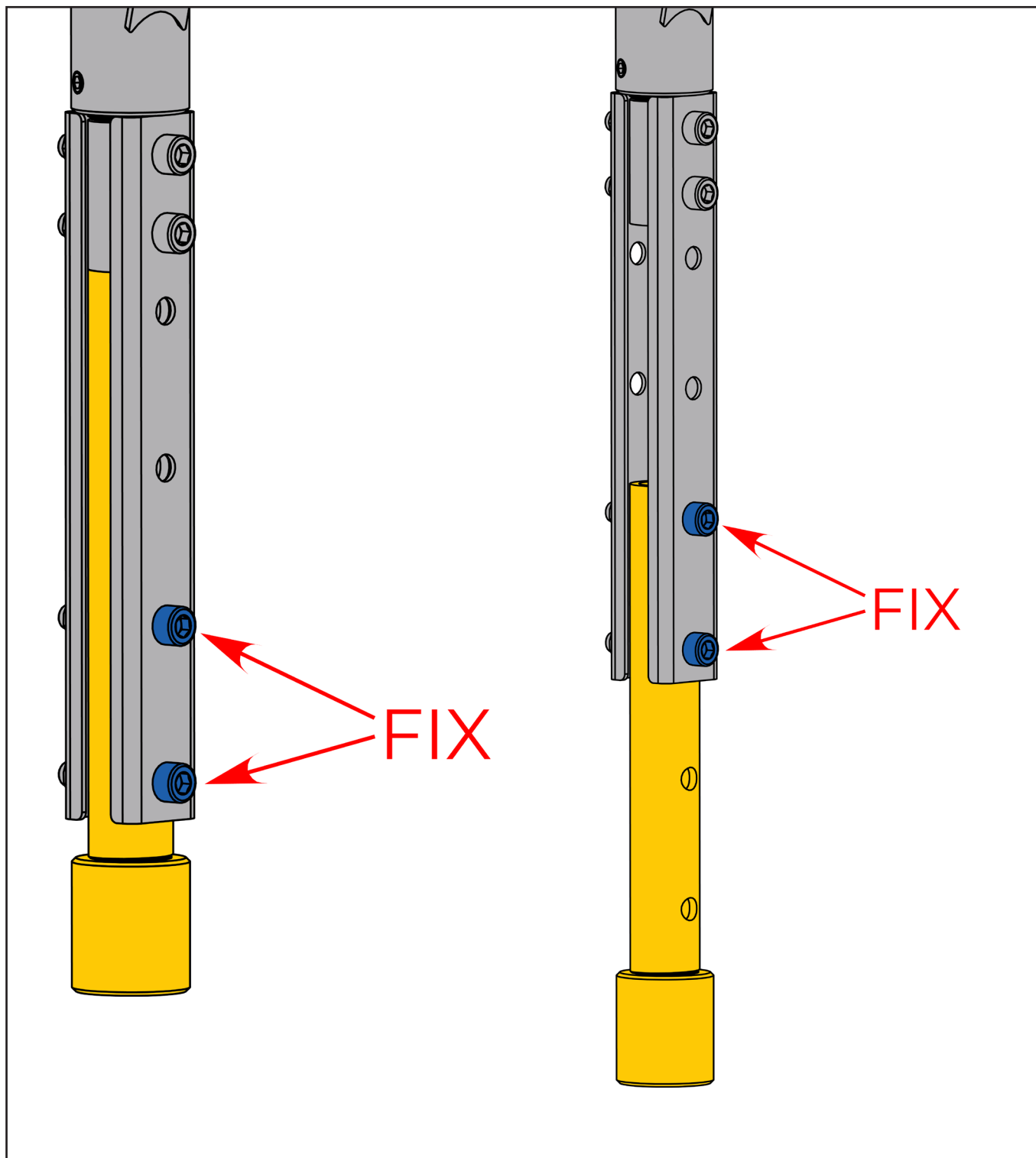

When using a telescopic tube, set the position as you want and fix it with bolts.